

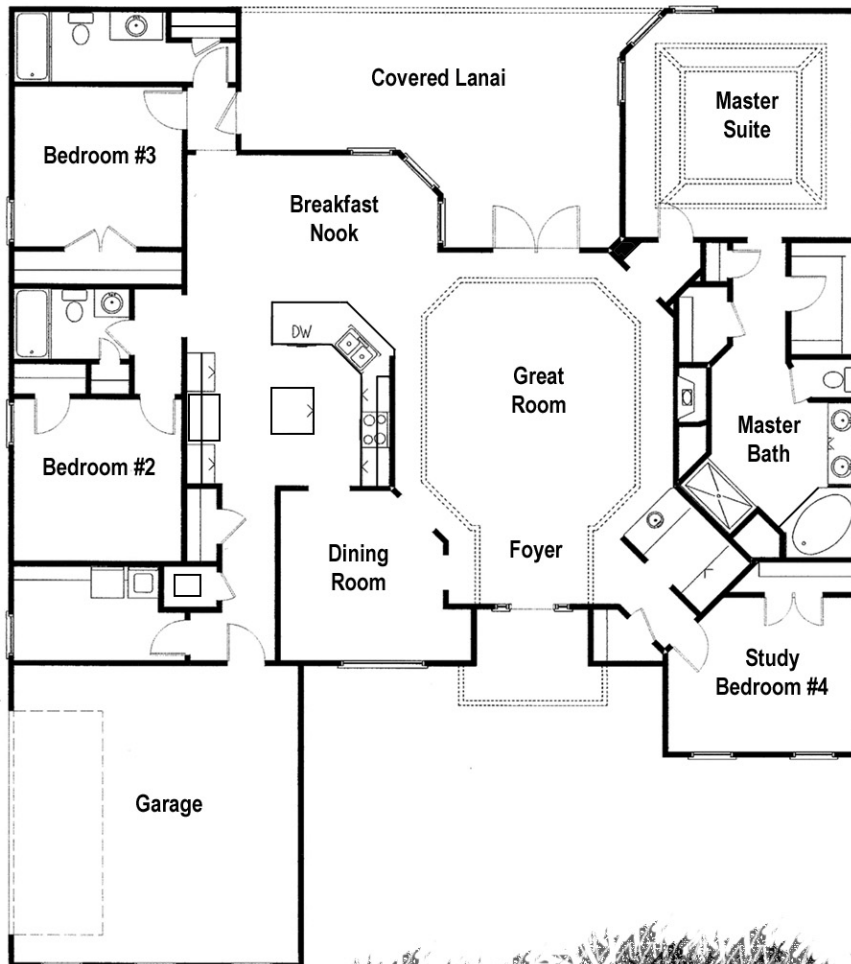

WESTERHEIM PROPERTIES

Custom Homes
Renovations • Sales



Plan 2545

- 2545 square feet
- 4 bedrooms / 3 baths
- Spacious great room
- Bonus room
- Covered front porch
- Fireplace option

Features shown may vary from available options. Elevations and floorplan specifications are subject to change without notice or prior obligation. Dimensions are approximate. Plans copyright Westerheim Properties 2012. LS 04/2012



Traditional Brick Elevation